

FOR LEASE

Former Albertsons | Fairwood

14215 SE PETROVITSKY ROAD, RENTON, WA 98058

RETAIL



PROPERTY FEATURES

- + Building size: 43,130 sq.ft.
- + Rental rate: \$12.00/SF/YR, NNN
- + Nearby tenants include Safeway, LA Fitness, Rite Aid, Bartell Drugs and more
- + Abundant retail parking
- + Zoning: CB Community Business Zone, King County

TRAFFIC COUNTS

- + 140th Avenue SE at SE Petrovitsky Road: 33,690 VPD
- + SE Petrovitsky Road at 140th Avenue SE: 19,880 VPD



CONTACT US

Scott Blankenship

+1 206 292 6084
scott.blankenship@cbre.com

Kathleen (KT) Taylor

+1 206 292 6091
kt.taylor@cbre.com

CBRE, Inc.

1420 5th Avenue, Suite 1700
Seattle, WA 98101

www.cbre.us

CBRE

FOR LEASE

Former Albertsons | Fairwood

14215 SE PETROVITSKY ROAD, RENTON, WA 98058

SITE PLAN

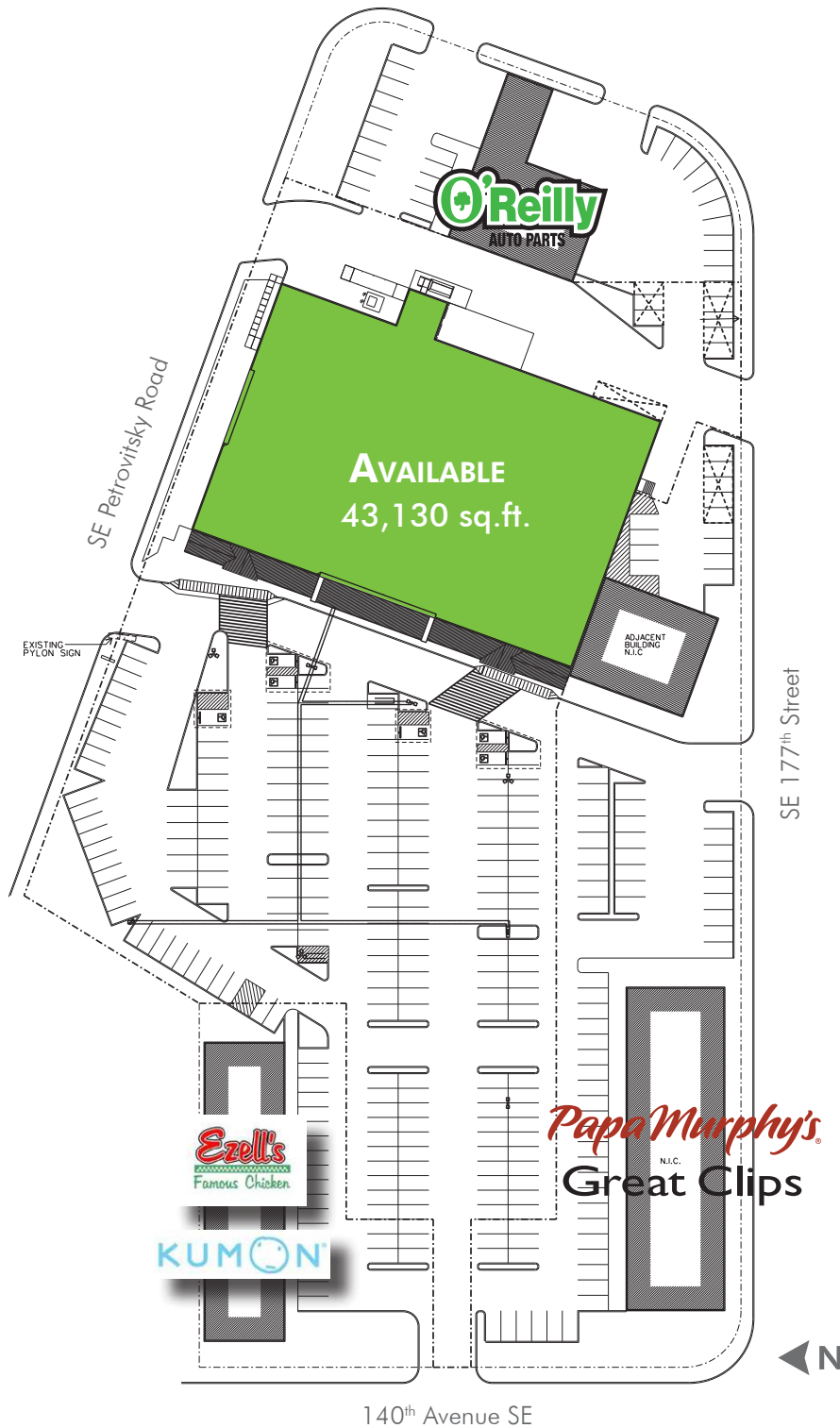

AMENITIES MAP

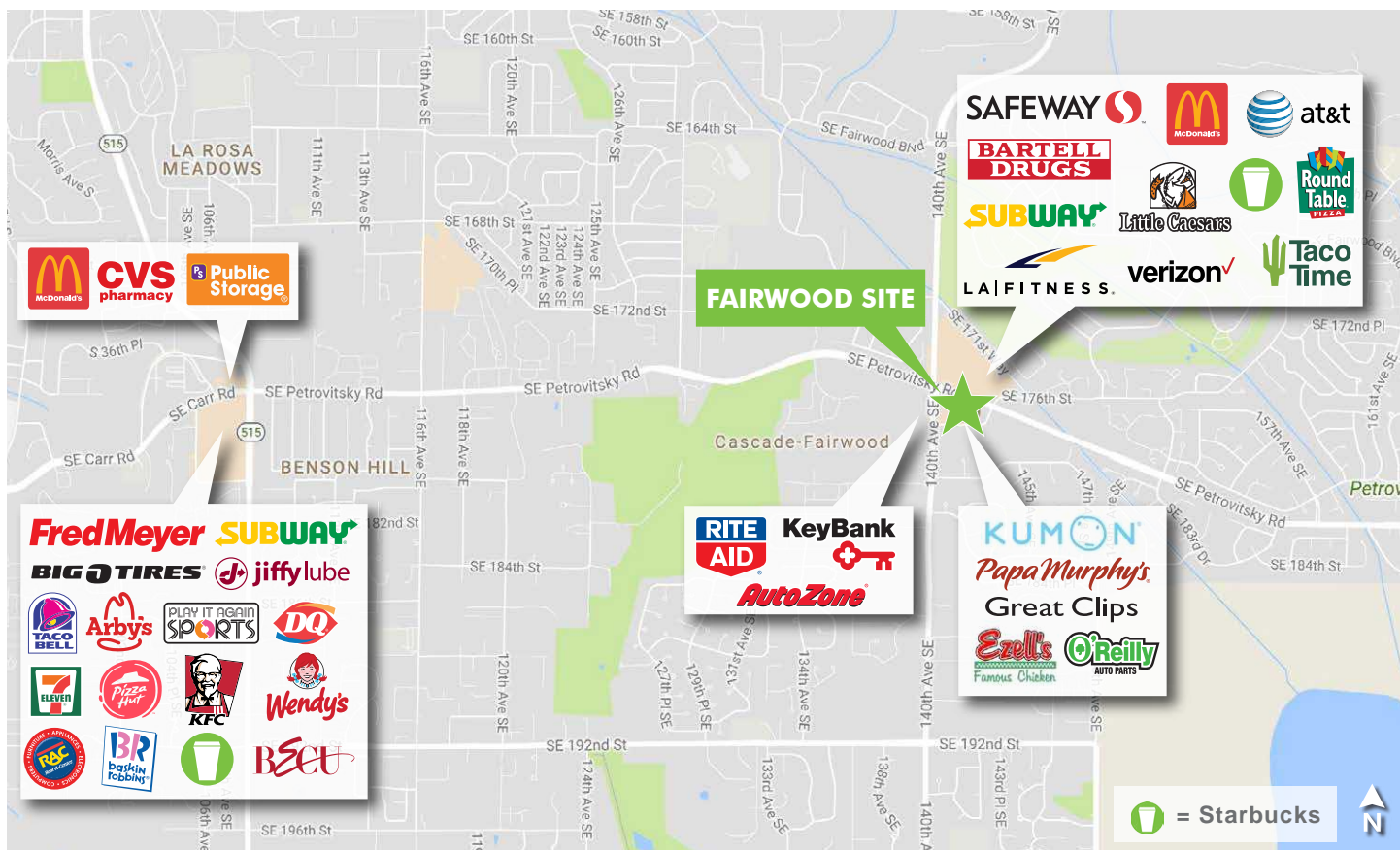

FOR LEASE

Former Albertsons | Fairwood

14215 SE PETROVITSKY ROAD, RENTON, WA 98058

RETAIL

2017 Estimated Demographics

		1 Mile	3 Miles	5 Miles
POPULATION	2017 Population - Current Year Estimate	12,978	90,167	201,595
	2022 Population - Five Year Projection	13,688	96,286	215,874
	2010 Population - Census	12,077	81,569	181,005
	2000 Population - Census	12,095	70,704	153,165
	2017 Median Age	39.4	38.5	37.7
HOUSEHOLDS	2017 Households - Current Year Estimate	5,027	32,691	73,637
	2022 Households - Five Year Projection	5,271	34,681	78,322
	2010 Households - Census	4,734	30,058	67,334
	2000 Households - Census	4,633	26,361	58,764
	Average Household Size	2.57	2.75	2.72
	Housing Units	3,280	22,734	46,444
RACE/ETHNICITY	White	61.3%	55.1%	53.7%
	Black or African American	9.0%	9.4%	9.8%
	Asian or Pacific Islander	19.2%	24.6%	24.0%
	American Indian or Alaska Native	0.4%	0.5%	0.6%
	Other Race	3.0%	3.9%	5.6%
	Hispanic	7.7%	9.4%	11.9%
INCOME	Average Household Income	\$106,846	\$99,519	\$94,812
	Median Household Income	\$86,608	\$80,652	\$76,719
	Per Capita Income	\$40,949	\$36,223	\$34,799
EDUCATION (Ages 25+)	Elementary (Grade Level 0 to 8)	2.1%	3.6%	4.4%
	Some High School (Grade Level 9 to 12)	3.6%	4.5%	5.1%
	High School Graduate	18.8%	21.6%	22.9%
	Some College	22.8%	22.1%	22.3%
	Associate`s Degree	11.0%	10.0%	9.4%
	Bachelor`s Degree	27.9%	26.9%	25.4%
	Graduate or Professional Degree	13.8%	11.2%	10.7%
BUSI- NESS	Total Businesses	239	1,299	6,530
	Total Employees	1,935	12,856	91,168

© 2017 CBRE, Inc. This information has been obtained from sources believed reliable. We have not verified it and make no guarantee, warranty or representation about it. Any projections, opinions, assumptions or estimates used are for example only and do not represent the current or future performance of the property. You and your advisors should conduct a careful, independent investigation of the property to determine to your satisfaction the suitability of the property for your needs. Photos herein are the property of their respective owners and use of these images without the express written consent of the owner is prohibited. CBRE and the CBRE logo are service marks of CBRE, Inc. and/or its affiliated or related companies in the United States and other countries. All other marks displayed on this document are the property of their respective owners. 9-13-17CK