

FOR LEASE - NEW OWNERSHIP

# THE SALAL CREDIT UNION BUILDING

9706

NE 4TH AVENUE

Seattle, WA 98115



[www.cbre.us/seattle](http://www.cbre.us/seattle)

**CBRE**



# FOR LEASE

## THE SALAL CREDIT UNION BUILDING

9706  
NE 4TH AVENUE  
Seattle, WA 98115



### PROPERTY HIGHLIGHTS

- + Proximity to:
  - Seattle Athletic Club
  - Northgate Mall
  - Northgate Transit Center
  - Future Northgate Link Light Rail Station
- + Class A building
- + Free parking (3/1,000 SF)
- + Efficient floor plates
- + Bike storage
- + Showers
- + Comcast fiber in building
- + Lease rate (FSG): Year 1 rate \$34.00 PSF

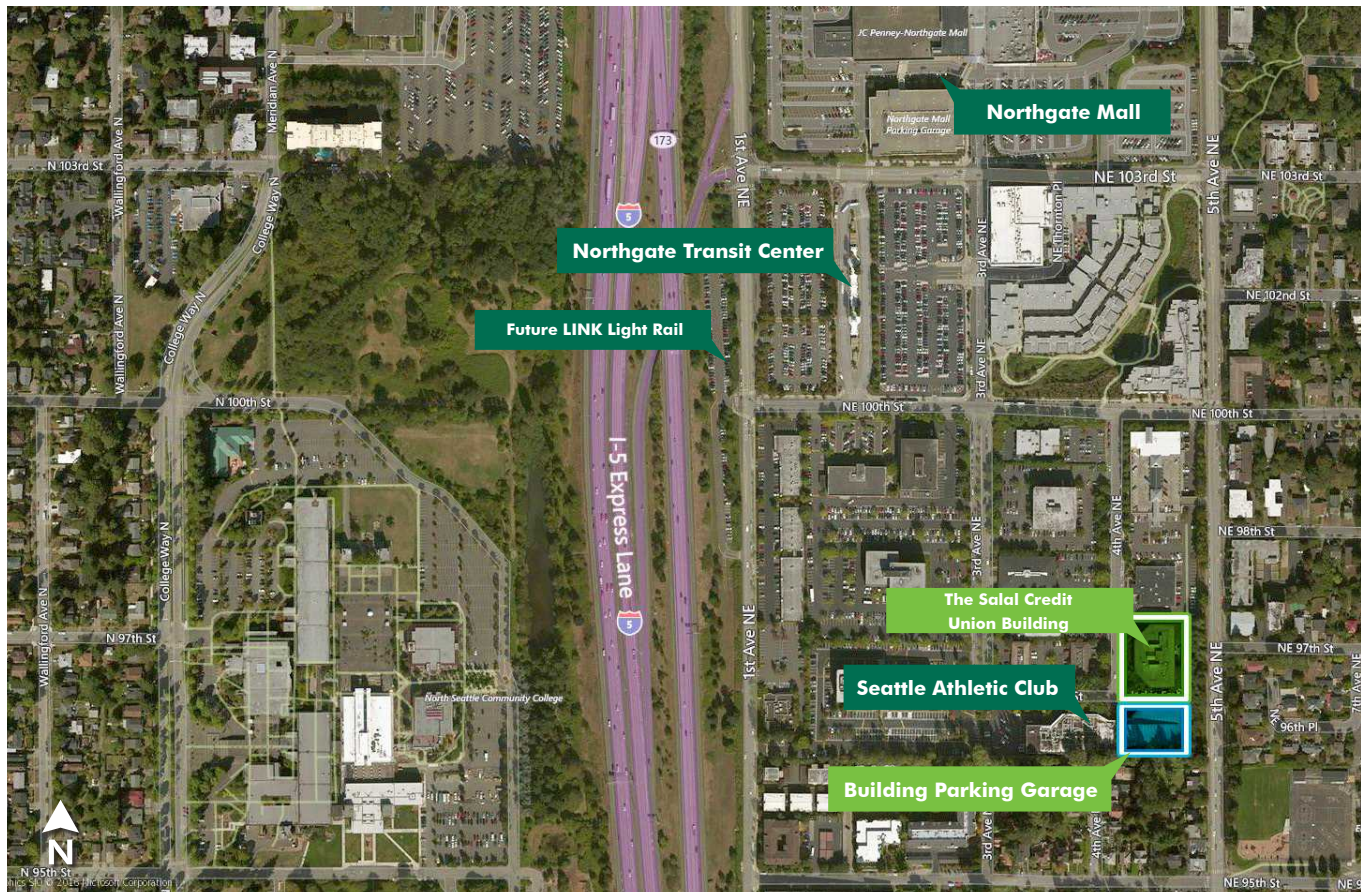
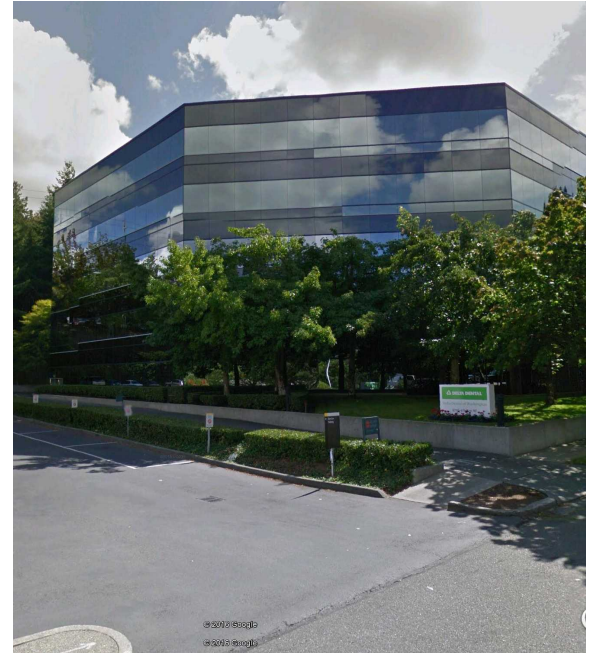



## FLOOR PLANS

### FLOOR 1

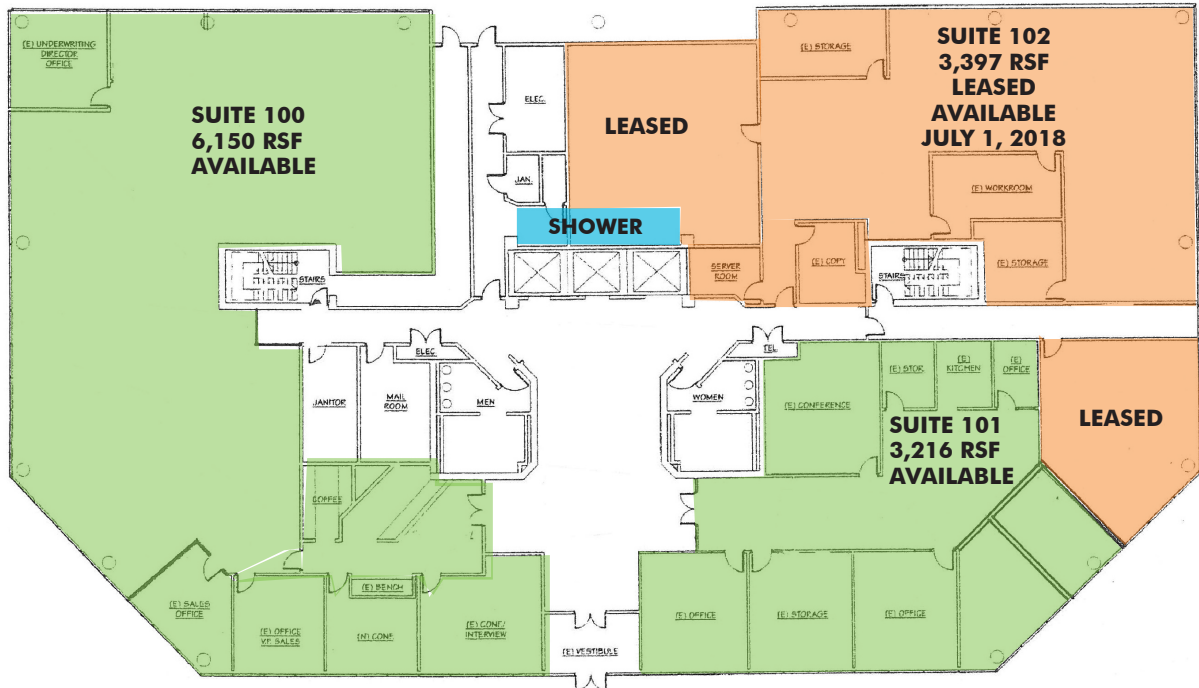

SUITE	SIZE ±RSF
100	6,150
101	3,216
102	3,397 (AVAILABLE 7/1/18)

FOR LEASE  
**THE SALAL CREDIT UNION BUILDING**

9706  
**NE 4TH AVENUE**  
 Seattle, WA 98115



**FLOOR PLANS**

**FLOOR 2**

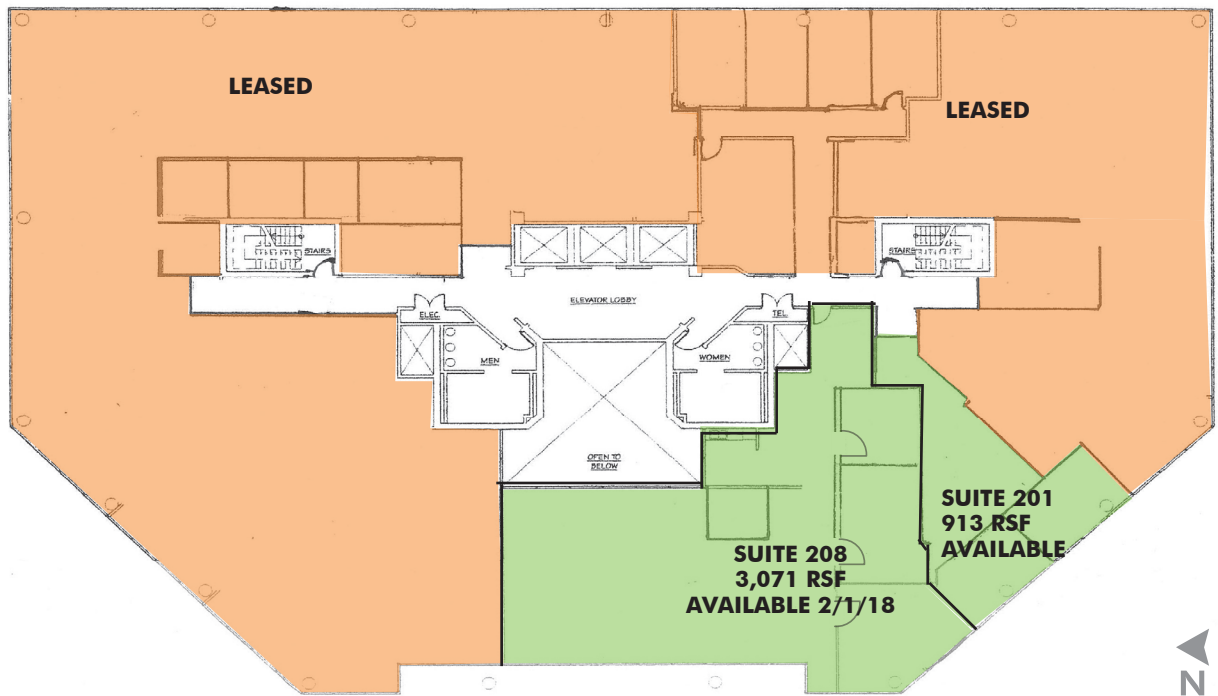

SUITE	SIZE ±RSF
201	913
208	3,071 (AVAILABLE 2/1/18)
201/208 COMBINED	3,984



FOR LEASE  
**THE SALAL CREDIT UNION BUILDING**

9706  
**NE 4TH AVENUE**  
 Seattle, WA 98115



**FLOOR PLANS**

**FLOOR 3**

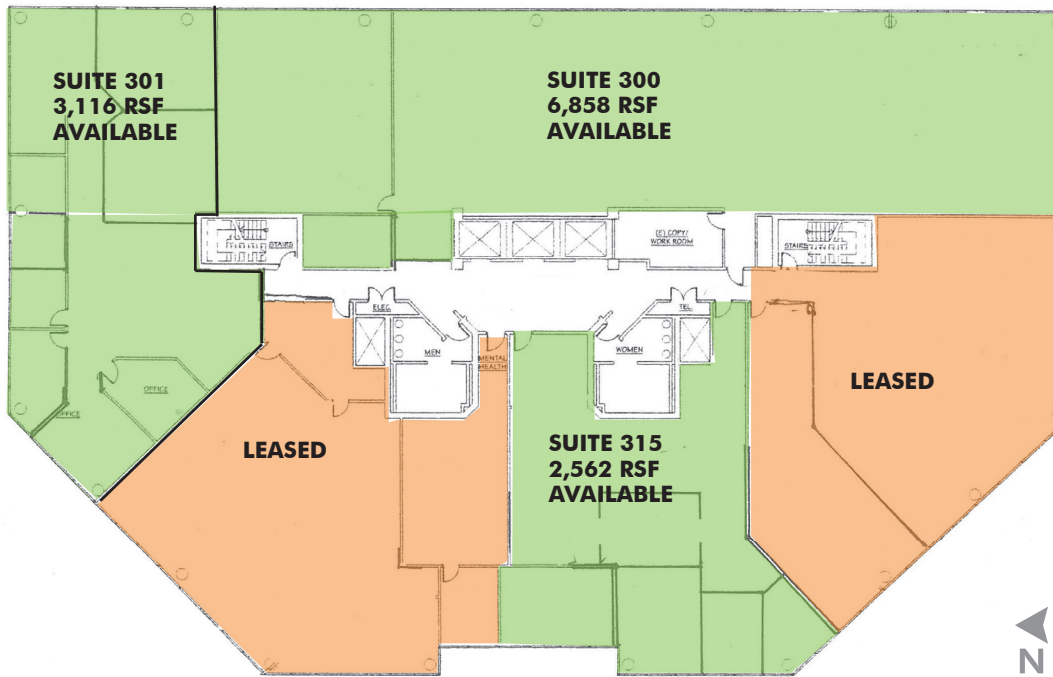

SUITE	SIZE ±RSF
300	6,858
301	3,116
300/301 COMBINED	9,974
315	2,562

# FOR LEASE

## THE SALAL CREDIT UNION BUILDING

9706  
NE 4TH AVENUE  
Seattle, WA 98115



### FLOOR PLANS

#### FLOOR 4



SUITE	SIZE ±RSF
401	7,500

# FOR LEASE THE SALAL CREDIT UNION BUILDING

9706  
NE 4TH AVENUE  
Seattle, WA 98115



## REGIONAL MAP

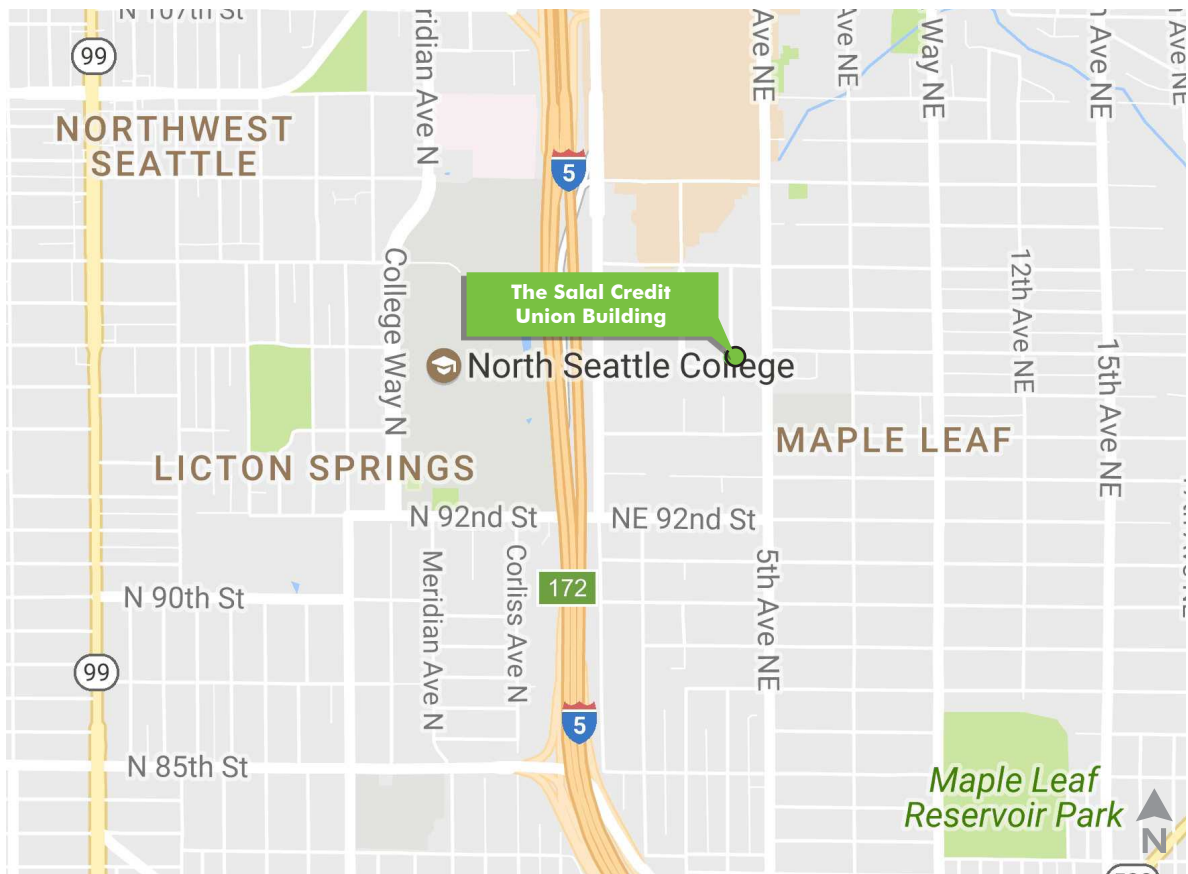

## CONTACT US

**DAN STUTZ**  
Senior Vice President  
+1 206 292 6097  
dan.stutz@cbre.com

**EVAN STEINRUCK**  
Associate  
+1 206 292 6022  
evan.steinruck@cbre.com

CBRE, Inc.  
1420 5th Ave,  
Suite 1700  
Seattle, WA 98101

© 2017 CBRE, Inc. This information has been obtained from sources believed reliable. We have not verified it and make no guarantee, warranty or representation about it. Any projections, opinions, assumptions or estimates used are for example only and do not represent the current or future performance of the property. You and your advisors should conduct a careful, independent investigation of the property to determine to your satisfaction the suitability of the property for your needs. Photos herein are the property of their respective owners and use of these images without the express written consent of the owner is prohibited. CBRE and the CBRE logo are service marks of CBRE, Inc. and/or its affiliated or related companies in the United States and other countries. All other marks displayed on this document are the property of their respective owners.11-14-17CK.