

Retail Property For Sale



623 & 627 W Garland

Property Information

2413 SF Building

- Located in the historic Garland District
- Land size 12,000 SF
- Excellent exposure and Parking (24 spots)
- Zoning: CC1-NC Center & Corridor: Commercial
- Property Taxes = \$3207.90 (2016)
- Tenant relocated

Sale Price ~~\$400,000.00~~
**** \$350,000.00 ****

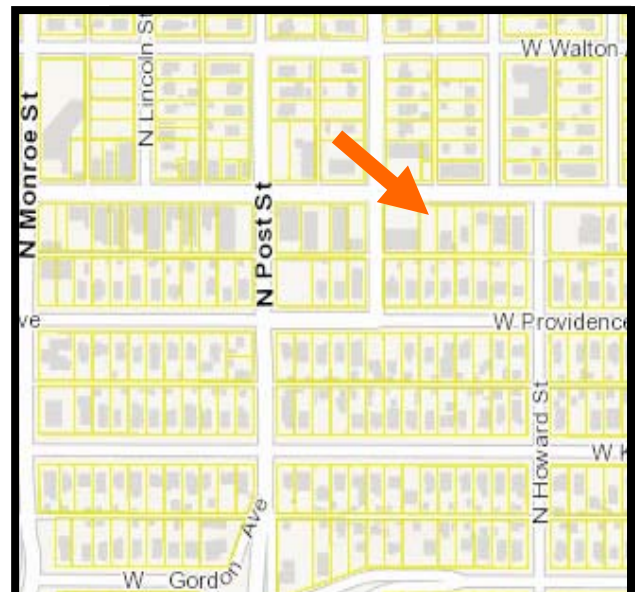

For Information Call

Mike Schmitz

509 462-9313 wk

509 979-0622 cell

Mike@sdsrealty.com

This information has been secured from sources we believe to be reliable, but we make no representations or warranties, express or implied, as to the accuracy of the information. References to square footage or age are approximate. Buyer/tenant must verify the information and bears all risks for any inaccuracies.

Site Plan



SDS REALTY Inc.
COMMERCIAL REAL ESTATE SERVICES

For Information Call
Mike Schmitz
509 462-9313 wk
509 979-0622 cell
Mike@sdsrealty.com

This information has been secured from sources we believe to be reliable, but we make no representations or warranties, express or implied, as to the accuracy of the information. References to square footage or age are approximate. Buyer/tenant must verify the information and bears all risks for any inaccuracies.