

Vacant Land For Sale

NAI Black

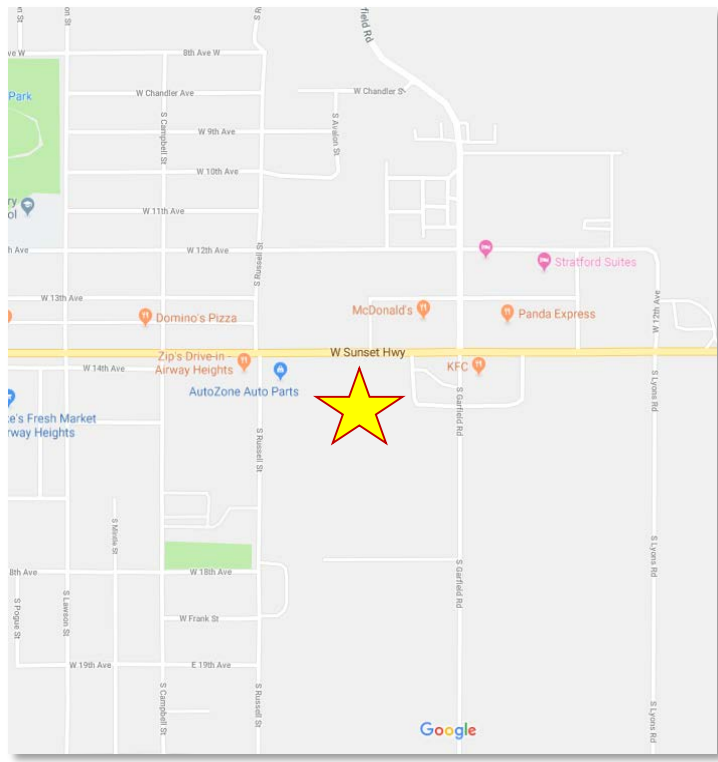

Hwy. 2 Between Russell St. & Garfield Rd.
Airway Heights, WA 99001

Property Features

- Total Land Size: 36 ± Acres
- 850 Feet of Frontage on Highway 2
- 980 Feet of Frontage on Russell Road
- 1,300 Feet of Frontage on Garfield Road
- Zoning: C-2, General Commercial, L-1 Light Industrial
- FAFB APZ, Airport Overlay Zone
- Water & Sewer: City of Airway Heights
- Electricity & Gas: Avista

For More Information, Contact:

John Powers

+1 509 622 3563
jpowers@naiblack.com

Drew Ulrick

+1 509 622 3562
dulrick@naiblack.com

Sale Price: \$4,250,000

NO WARRANTY OR REPRESENTATION, EXPRESS OR IMPLIED, IS MADE AS TO THE ACCURACY OF THE INFORMATION CONTAINED HEREIN, AND THE SAME IS SUBMITTED SUBJECT TO ERRORS, OMISSIONS, CHANGE OF PRICE, RENTAL OR OTHER CONDITIONS, PRIOR SALE, LEASE OR FINANCING, OR WITHDRAWAL WITHOUT NOTICE, AND OF ANY SPECIAL LISTING CONDITIONS IMPOSED BY OUR PRINCIPALS NO WARRANTIES OR REPRESENTATIONS ARE MADE AS TO THE CONDITION OF THE PROPERTY OR ANY HAZARDS CONTAINED THEREIN ARE ANY TO BE IMPLIED

Black Commercial, Inc.
801 W Riverside, Suite 300
Spokane, Washington 99201
+1 509 623 1000
naiblack.com

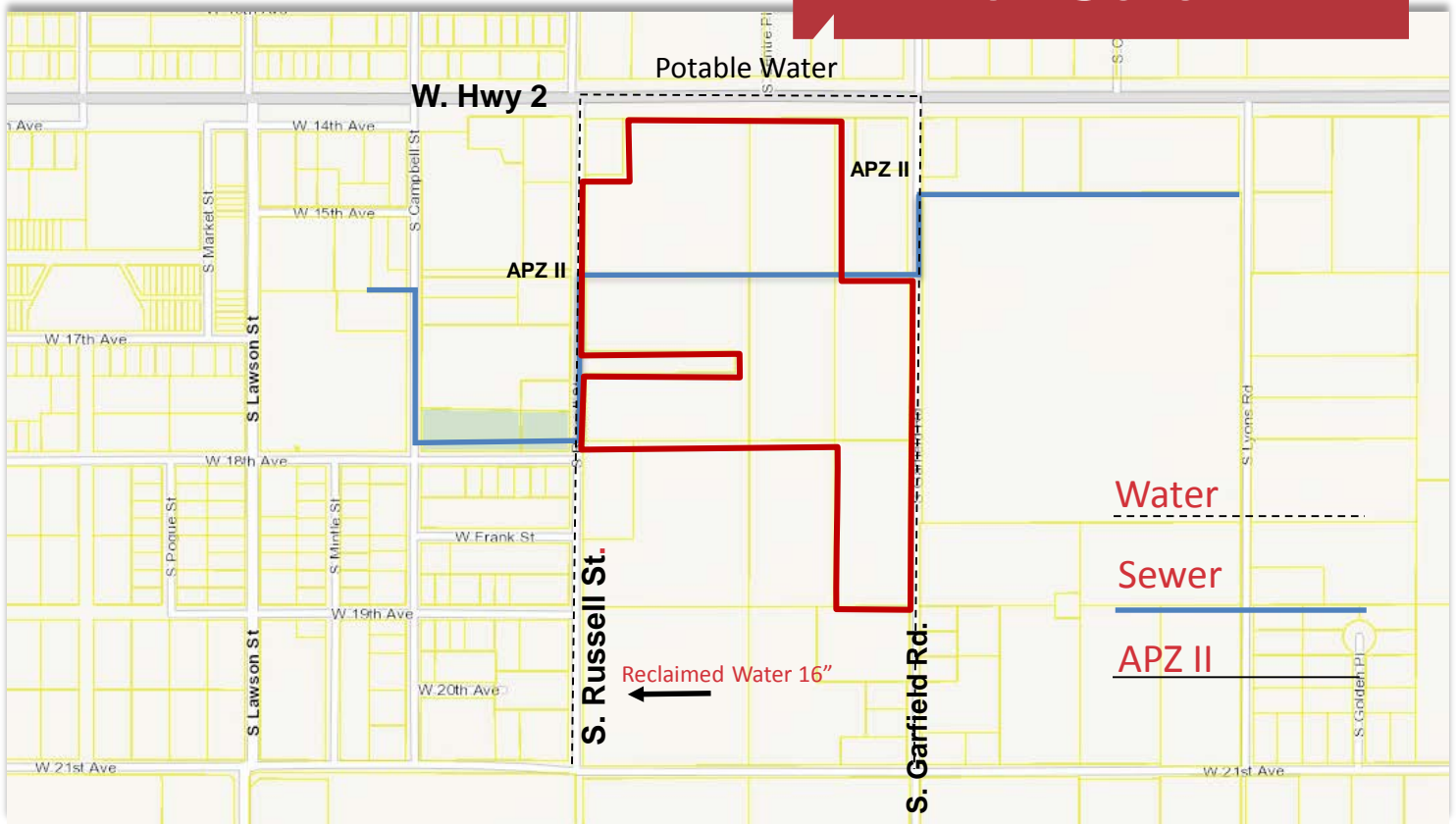

2017 Demographics:

Population	1 Mile Radius	6,669
	3 Mile Radius	11,563
	5 Mile Radius	20,093
Median Household Income	1 Mile Radius	\$47,240
	3 Mile Radius	\$50,871
	5 Mile Radius	\$54,039
Average Household Income	1 Mile Radius	\$55,763
	3 Mile Radius	\$64,901
	5 Mile Radius	\$70,599

Parcel Number Breakdown:

- 15252.0106: 8.72 AC
- 15252.0304: 8.45 AC
- 15252.0153: 4.85 AC
- 15252.0154: 5.15 AC
- 15252.0156: 4.55 AC
- 15252.0155: 4.55 AC

Traffic Counts: Hwy 2 & S. Garfield Rd. 24,000 ±VPD

For More Information, Contact:

John Powers

+1 509 622 3563

jpowers@naiblack.com

Drew Ulrick

+1 509 622 3562

dulrick@naiblack.com